

Outparcel Available

South Mt. Juliet Road

Mt Juliet, Tennessee 37122

- 1.45 Acre Outparcel for Sale or Lease
- \$1.3 Million Sales Price
- \$80,000/year Ground Lease
- Last out-parcel available on South Mt Juliet Rd across from Providence
- Frontage on South Mt Juliet Road across from Publix
- Just south of Providence Marketplace and Interstate 40
- Newly Constructed 22,300+/-sf Retail Strip Center and 35,000sf Medical Office Building located next to site,
- Signalized traffic light at main entrance
- Regional shopping corridor pulls from up to 20 miles away

Graves Crossings

22,300sf Retail
Strip Center,
35,000sf Medical
Office Building and
Outparcels
Located in
Mt Juliet TN

For more information, contact:

Bryan Chance
615.969.1707 cell
bryan@capitalcorporation.net
Tiffanie Fitzpatrick
615.554-0646 cell
tiffanie@capitalcorporation.net

80 Cude Lane
Madison, TN 37115
615.855.2230
615.855-2580 fax



THE
CAPITAL
CORPORATION



630 S Mt Juliet Road
Mt Juliet, TN



Other Providence
Tenants Include:

- Publix
- Target
- Kroger
- Walgreens
- Belk
- Books A Million
- Best Buy
- Old Navy
- JC Penney

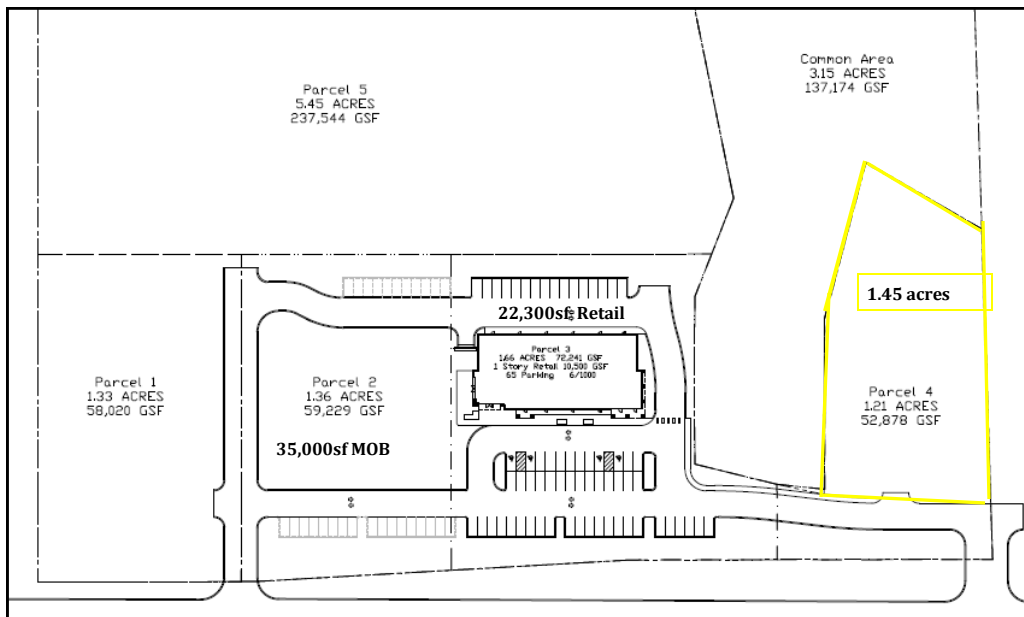

Other Quick Facts

- Mt. Juliet city limits boasts a population close to 30,000 (2010).
- Wilson County is one of the top 5 most affluent counties in TN and 2nd highest median income in the State.
- For the fifth year in a row, Mt. Juliet was again named as one of Tennessee's top 5 "Most Business Friendly Cities" and in 2011



THE
CAPITAL
CORPORATION